

REVISIONS				
REV	ECN	DESCRIPTION	DATE	APPROVED
P		CAGE COVER MATERIAL CHANGE	28/11/08	ZLJ

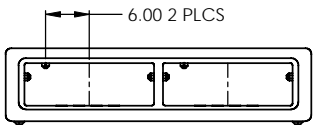

KEY #1-1

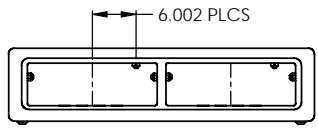

KEY #7-7

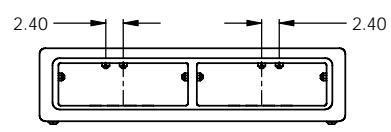

KEY #2, 4 - 4, 6

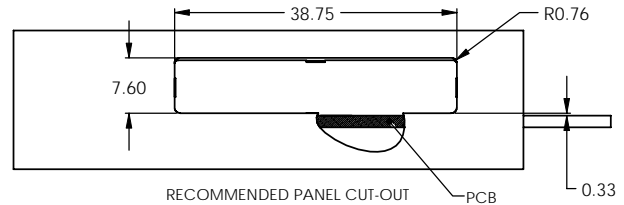

RECOMMENDED PANEL CUT-OUT

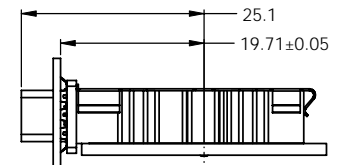

RECOMMENDED FACE PLATE TO LOCATING POST DISTANCE

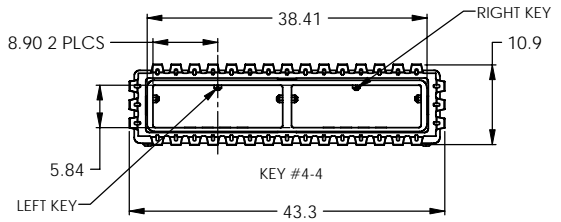
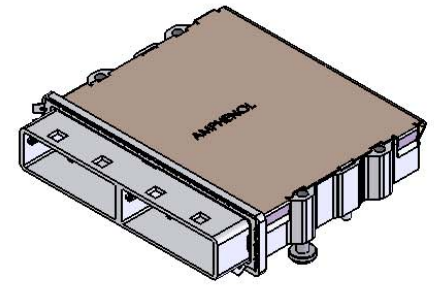

KEY #4-4

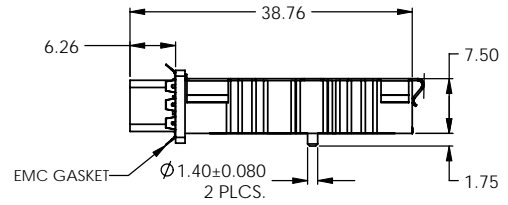

EMC GASKET

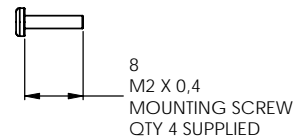

8  
M2 X 0.4  
MOUNTING SCREW  
QTY 4 SUPPLIED

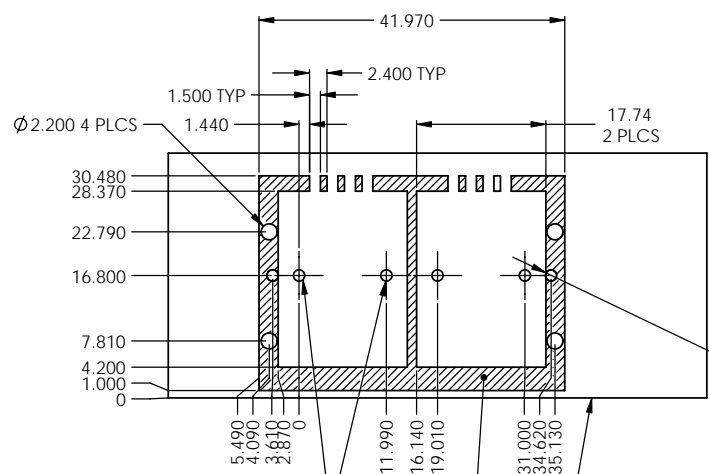

SIGNAL CONNECTOR LOCATING HOLES

PLATED AREA OF PCB (GROUND)

FRONT EDGE OF PCB

RECOMMENDED PCB LAYOUT

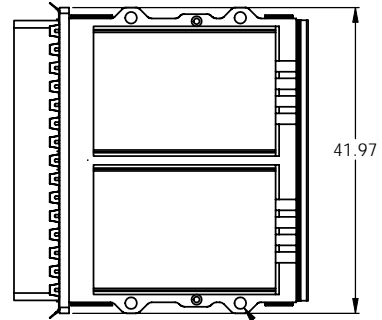

M2 X 0.4  
4 PLCS



Left Key Option	Right Key Option	Part Number	Description
0	0	FS1-SF2-10E1	No Key
1	1	FS1-SF2-11E1	SATA X Cable
4	4	FS1-SF2-14E1	SAS Universal Port
7	7	FS1-SF2-17E1	SATA M Cable
2, 4	2, 4	FS1-SF2-1D22E1	SAS Out Port
4, 6	4, 6	FS1-SF2-1D66E1	SAS In Port
2, 4	4, 6	FS1-SF2-1D26E1	SAS Out/In Port
4, 6	2, 4	FS1-SF2-1D62E1	SAS In/Out Port

DO NOT SCALE DRAWING

THIS DOCUMENT CONTAINS PROPRIETARY INFORMATION AND SUCH INFORMATION MAY NOT BE DISCLOSED TO OTHERS FOR ANY PURPOSE OR USED FOR MANUFACTURING PURPOSES WITHOUT PERMISSION FROM AMPHENOL CANADA CORP.

NOTES:

- MATERIAL:  
MAIN CAGE: ZINC DIECAST SHELL WITH 150 MICRONS OF NICKEL PLATING  
EMC GASKET: STAINLESS STEEL  
COVER: STAINLESS STEEL
- ROHS COMPLIANT
- COMPLIES WITH SFF-8088 EXCEPT WHERE NOTED \*\*\*.

UNLESS OTHERWISE SPECIFIED, DIMENSIONS ARE IN MILLIMETERS. TOLERANCES ARE: XX ± 0.25 XX ± 0.10 XXX ± 0.05 MATERIAL AND FINISH	APPROVALS	DATE	Amphenol Canada Corp.
	DESIGN YK	06/DEC/06	
ENG'N: EAR 123XX	CHECKED YK	06/DEC/06	SFF SPECIAL, CAGE 1 X 2, 0 DEGREE
CODE IDENT NO: 03554	SA APP'D		
	REV APP'D		REV P
	ENG APP'D		REV NTS
			PROJECT SFF
			SHEET 1 OF 1